

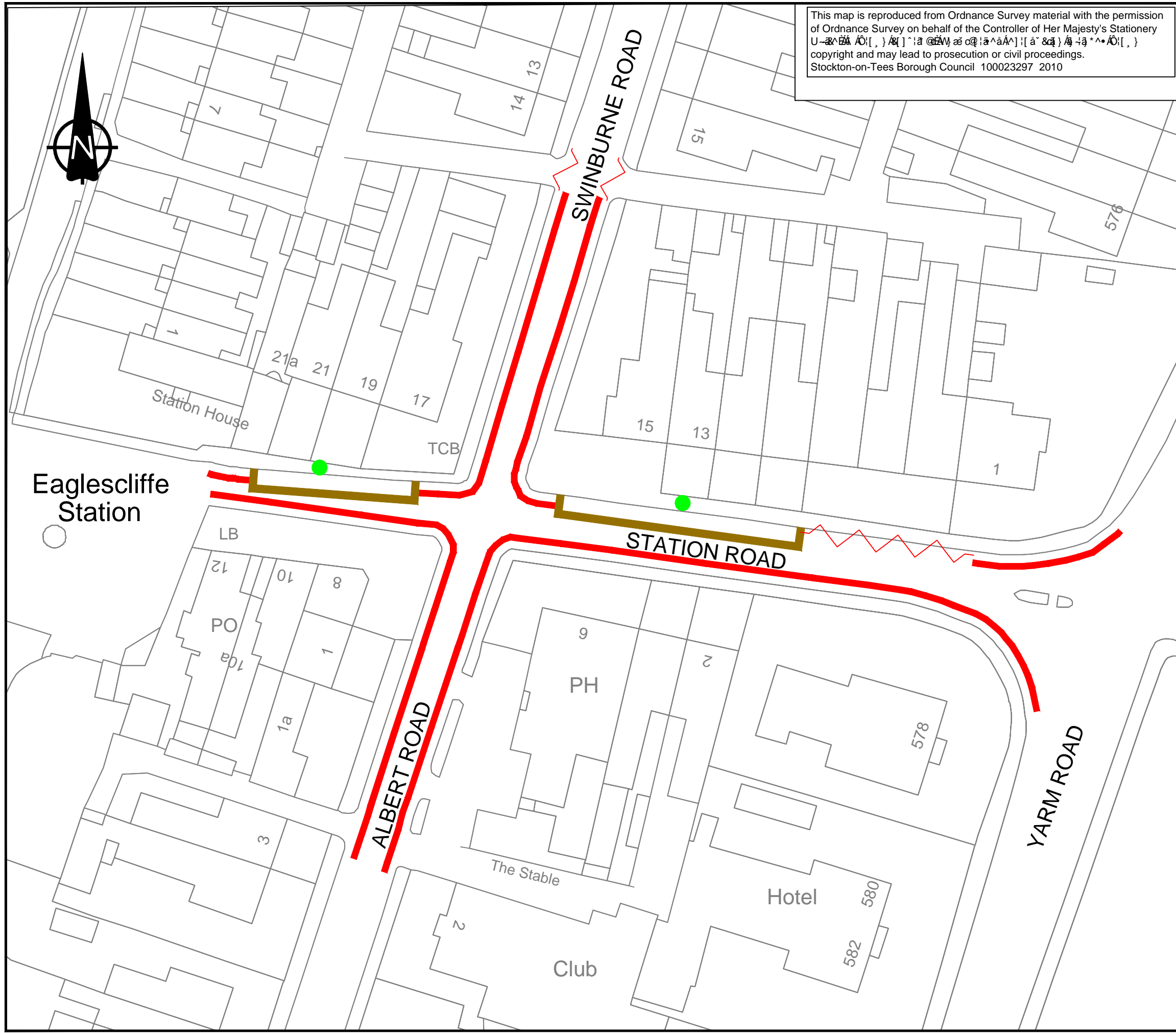



This map is reproduced from Ordnance Survey material with the permission of Ordnance Survey on behalf of the Controller of Her Majesty's Stationery Office. All rights reserved. No part of this publication may be reproduced, stored in a retrieval system, or transmitted in any form or by any means, electronic, mechanical, photocopying, recording, or by any information storage or retrieval system, without the prior written permission of Ordnance Survey. Ordnance Survey is a registered trademark of Ordnance Survey Limited. This map is reproduced from Ordnance Survey material with the permission of Ordnance Survey on behalf of the Controller of Her Majesty's Stationery Office. All rights reserved. No part of this publication may be reproduced, stored in a retrieval system, or transmitted in any form or by any means, electronic, mechanical, photocopying, recording, or by any information storage or retrieval system, without the prior written permission of Ordnance Survey. Ordnance Survey is a registered trademark of Ordnance Survey Limited. Stockton-on-Tees Borough Council 100023297 2010

This drawing should not be scaled. All dimensions must be checked on site and contractor to report any omissions or errors to the contract administrator



NOTES

Key

-  Proposed limited waiting restrictions Mon - Sat, 8am - 6pm 2 hour.
-  24 hour waiting restrictions.
-  Proposed 24 hour waiting restrictions.



Rev	Description	Drn	Chk	Date
Drawing Status PRELIMINARY <input type="checkbox"/> APPROVAL <input type="checkbox"/>				
INFORMATION <input type="checkbox"/> TENDER <input type="checkbox"/> CONSTRUCTION <input type="checkbox"/>				



Stockton-on-Tees
BOROUGH COUNCIL
Passionate about Stockton-on-Tees

Development & Neighbourhood Services
Acting Head of Technical Services Richard McGuckin B.Eng., C.Eng., M.I.C.E.
P.O.Box 229, Kingsway House, West Precinct, Billingham, TS23 2YL. Telephone (01642) 393939. E-mail: technicalservices@stockton.gov.uk

Project
**STATION ROAD AREA
EAGLESLIFFE**

Content
**PROPOSED RESIDENTIAL
PARKING SCHEME**

Date	SEPT '10	Drg No.	TMS/116
Drawn	LSS	Checked	AT
Scales @ A3	1:500		Rev